

Arranged by Motor Type then Discharge Size

Model	Discharge		Suction		Solids Size	Mount Style	Impeller		Motor Type	Max HP		
	Size	Type	Size	Type			Nom.	Type		1150 RPM	1750 RPM	3450 RPM
2814	3	ANSI	3	ANSI	2 1/2	V	7	Semi-Open	SUB	1	5	--
2815	4	ANSI	4	ANSI	2 1/2	V	7	Semi-Open	SUB	1	5	--
2816	4	ANSI	4	ANSI	3	V	9	Enclosed	SUB	5	10	--
2832	2	ANSI	2	ANSI	3/4	H	5	Enclosed	NEMA	--	--	5
2852	2	ANSI	3	NPT	Grinder	H	7	Semi-Open	NEMA	--	1 1/2	7 1/2
2882	2	NPT	2	NPT	1 1/2	H	5	Vortex	NEMA	--	--	3
2834	3	ANSI	3	ANSI	Slicer	V, H	7	Semi-Open	NEMA	--	5	--
2856	3	ANSI	3	ANSI	1/2	V, H	7	Enclosed	NEMA	--	5	30
2857	3	ANSI	4	ANSI	3/4	V, H	7	Enclosed	NEMA	--	5	40
2854	3	ANSI	3	ANSI	2 1/2	V, H	7	Semi-Open	NEMA	--	5	10
2836	4	ANSI	4	ANSI	Slicer	V, H	7	Semi-Open	NEMA	--	5	--
2838	4	ANSI	4	ANSI	Slicer	V, H	9	Enclosed	NEMA	--	15	--
2863	4	ANSI	4	ANSI	13/16	V, H	9	Enclosed	NEMA	--	20	--
2855	4	ANSI	4	ANSI	2 1/2	V, H	7	Semi-Open	NEMA	--	5	10
2879	4	ANSI	4	ANSI	2 1/2	V, H	13	Enclosed	NEMA	15	40	--
2875	4	ANSI	4	ANSI	3	V, H	9	Enclosed	NEMA	5	15	--
2878	4	ANSI	4	ANSI	3	V, H	13	Enclosed	NEMA	20	--	--

H = Horizontal Mount
V = Vertical Mount

Horizontal and vertical dry well pumps are designed to be installed in a dry area adjacent to, and taking its suction from a wet collection well.

Dry well pumps are used with above ground wet storage tanks. Install with a valve on the suction side, and a valve and check-valve on the discharge side. A compact, easy-to-install and maintain pump arrangement is possible.

Models 2814, 2815 and 2816 models are matched to a Weil double-sealed submersible motor. This style of pump is used in locations where flooding of a dry well may occur.

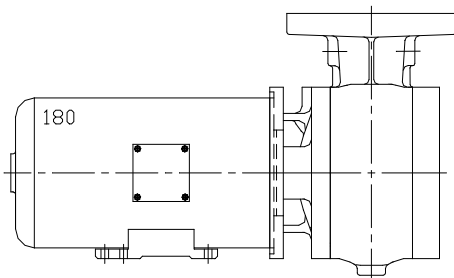

**Horizontal Mount
NEMA Motor**

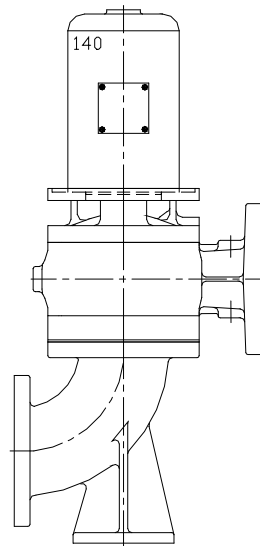

**Vertical Mount
NEMA Motor**

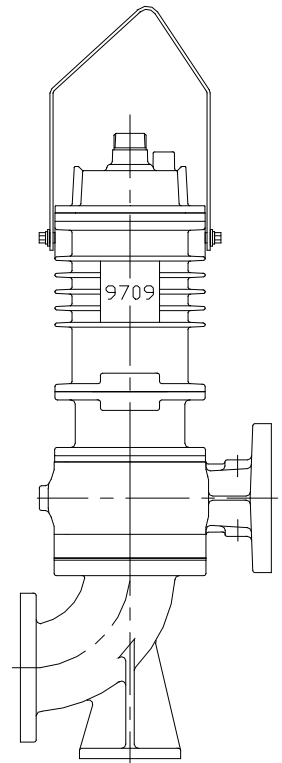

**Vertical Mount
Submersible Motor**

Select vertical mount floor elbow based on suction size:

Suction Size	Order Number
3 Inch	2800K1001
4 Inch	2800K1002

Elbows are ANSI flanged 90° with foot mounting

- ANSI** American National Standard Institute 125# flange connection. Provided with flange holes for bolts.
- NPT** National Pipe Taper. Discharge has an internal threaded connection suitable for threaded pipe.